

## CAMERA INSTALLATION GUIDE

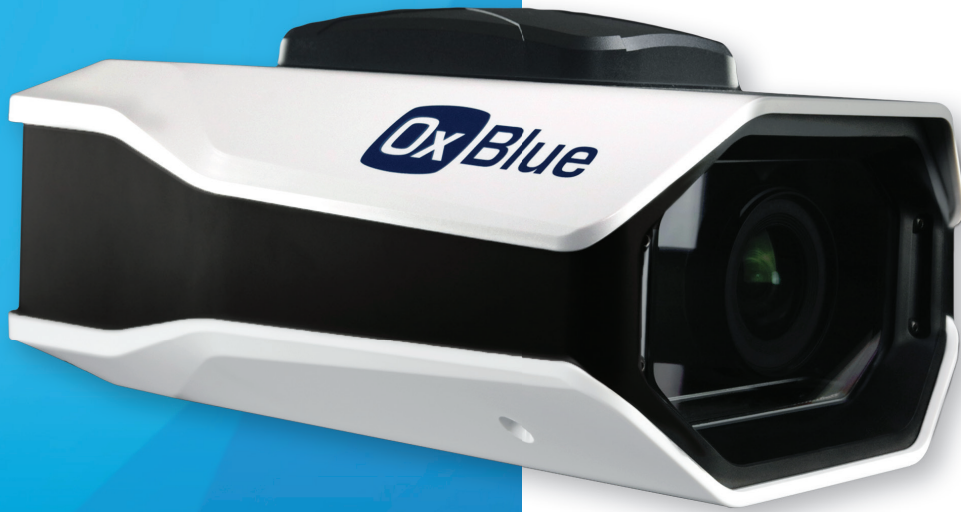

# COBALT SERIES



### WE'RE HERE TO HELP

---

Your Client Support Manager will be the primary contact for technical support. The team is available at **+44 (20) 45186562** (Monday-Friday 9am-5pm).

### OXBLUE CLIENT SUPPORT

**+44 (20) 45186562 - Office**

# COMPLETE THESE STEPS BEFORE INSTALLATION

## 1 CONNECT TO POWER

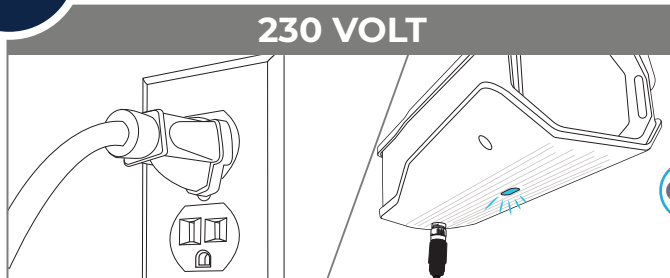

Verify the blue light on the bottom of the camera is on.

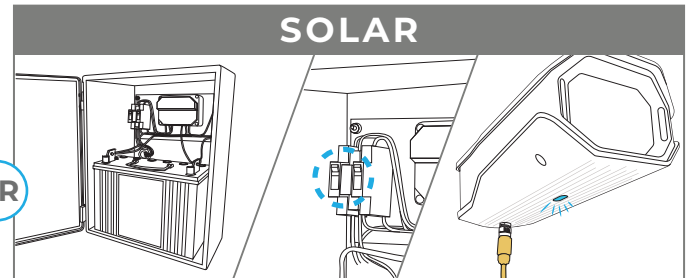

Hook up battery & connect camera to cabinet. Turn the breakers on. Verify the blue light on the bottom of the camera is on.

## 2 ACTIVATE CAMERA

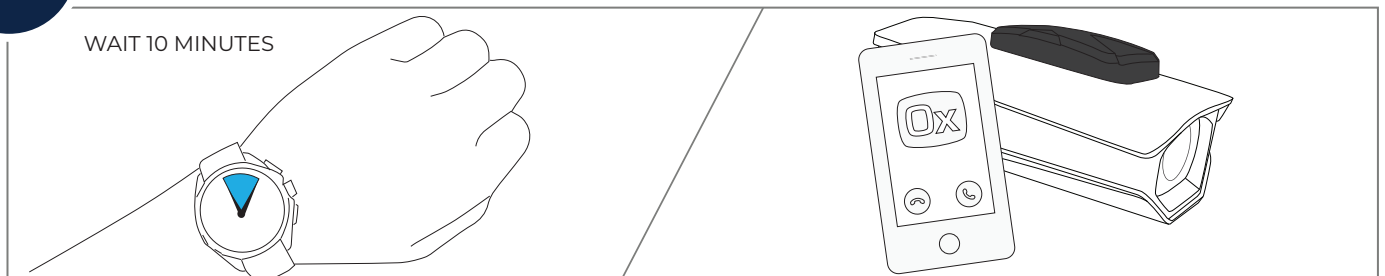

Call +44 (20) 45186562 (M-F 9-5) to confirm image transmission and activation. Have your camera ID located on the front cover ready.

## 3 MOUNT BRACKET

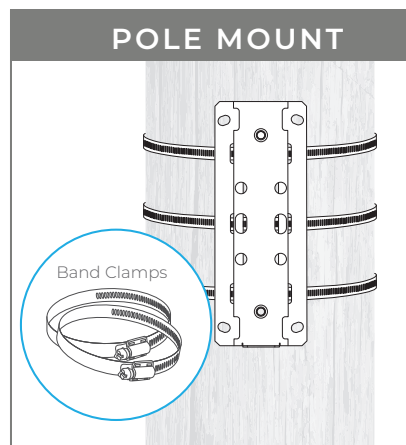
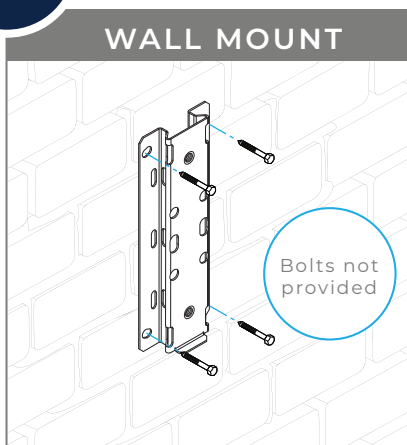

Install quick connect bracket to your preferred mounting substrate.

*It is the contractor's responsibility to meet all code requirements, and to obtain any and all permits necessary.*

# 4

## ATTACH MOUNT

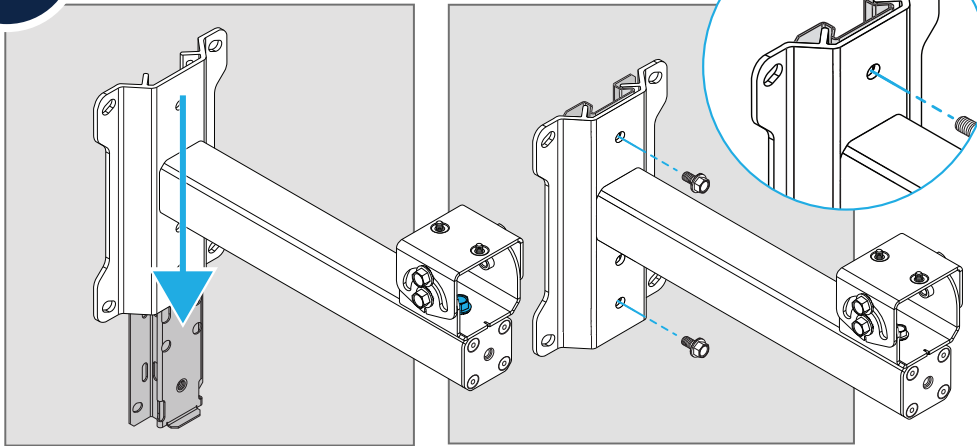

Slide universal mount base onto quick connect bracket and secure using the two bolts on the mount.

# 5

## ATTACH CAMERA TO MOUNT

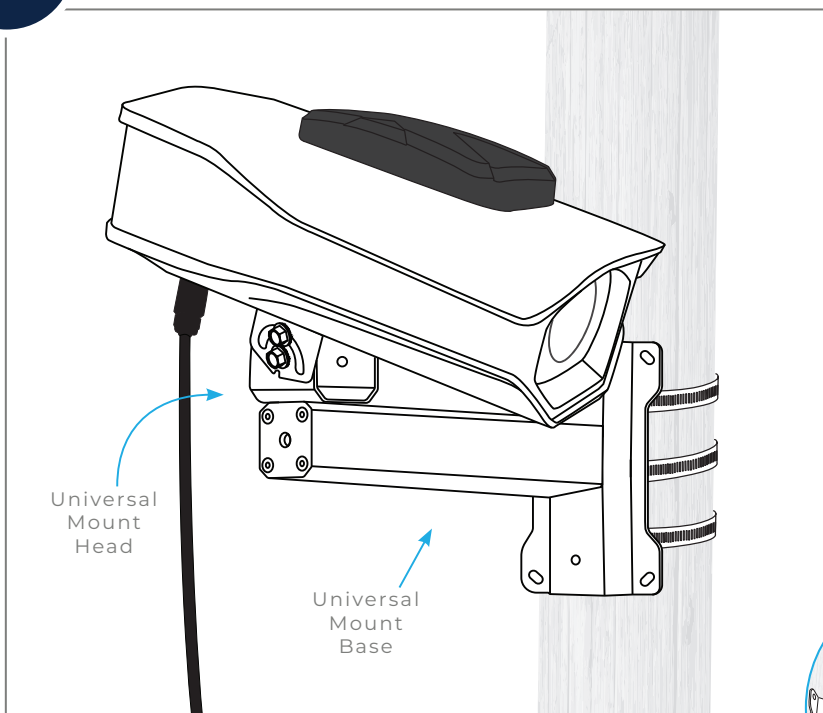

Attach camera to mount head using the screws on the base of your camera.

- Adjust camera direction by rotating the mount head at the end of the universal mount base; Tighten bolt to hold position.
- Adjust camera angle by loosening the four bolts on the sides of the mount head and pivot along channel tracks; Tighten bolts to position.
- Make sure the power cable isn't tweaked - point the mount in a different direction then adjust the camera angle as shown in diagram 5.

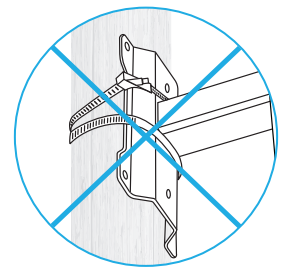
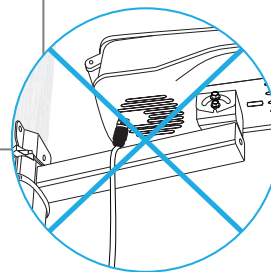

### ATTENTION

SAVE BOX & FOAM FOR CAMERA  
RETURN AT END OF PROJECT  
RETURN LABEL INCLUDED

### INSTALLATION TIPS

- Ensure your camera is level.
- The camera has a field of view up to 97°.
- Place the camera outside of the construction area to capture maximum activity.
- Ideal area to mount a camera is in a corner.

# OPTIONAL TETHER INSTALLATION

In areas where there is risk of a falling camera causing injury or significant damage, a 0.79 mm wire rope with a minimum 68 kg breaking strength is recommended to be installed separately to the camera and camera mount, and then back to the structural support. For tether equipment, contact your client support manager.

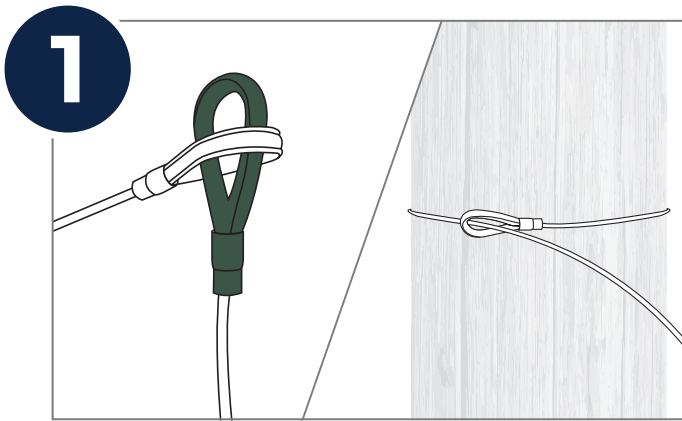

Loop tether cable around pole and feed **green** loop into the other.

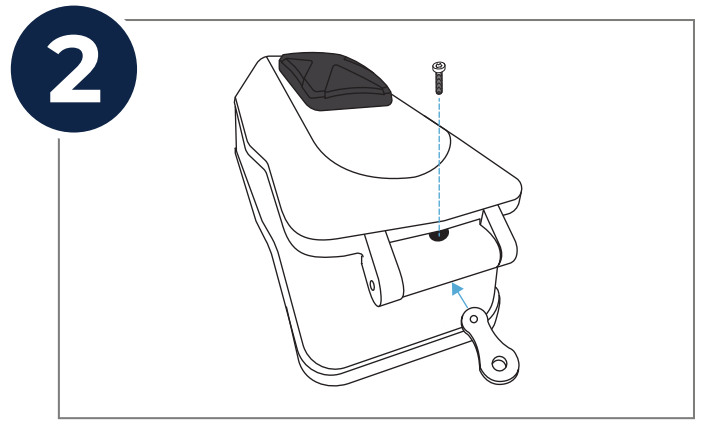

Connect anchor to the unit.

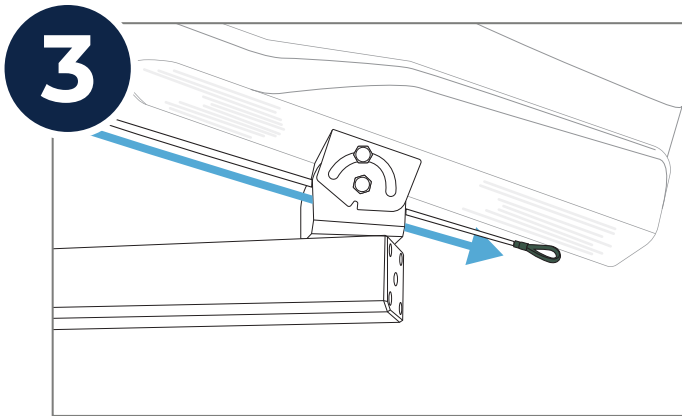

Loop the tether through the mount.

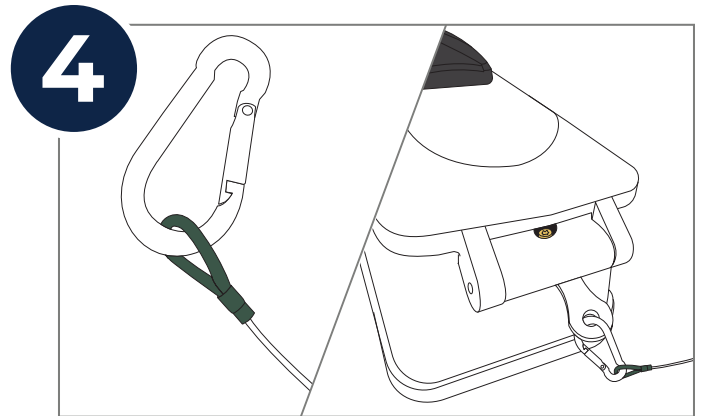

Connect tether to the camera with the carabiner.